

Instruction manual

Smart Wireless Mini ZigBee Switch LZ4

You will need Nous Smart Home App. Scan the QR code or download it from [direct link](#)



LED at the bottom

- **Blinking:** The device enters Zigbee network configuration mode (preparing to connect the gateway)
- **OFF:** The device is under standby status

Button at the bottom

- **Reset or enter configuration mode:** Press and hold the button for 5 seconds until the blue LED blinks, the device will enter configuration mode

How to add your device to the Nous Smart app

- Open Nous Smart Home app, on smart gateway homepage,
Click: Zigbee Smart Gateway

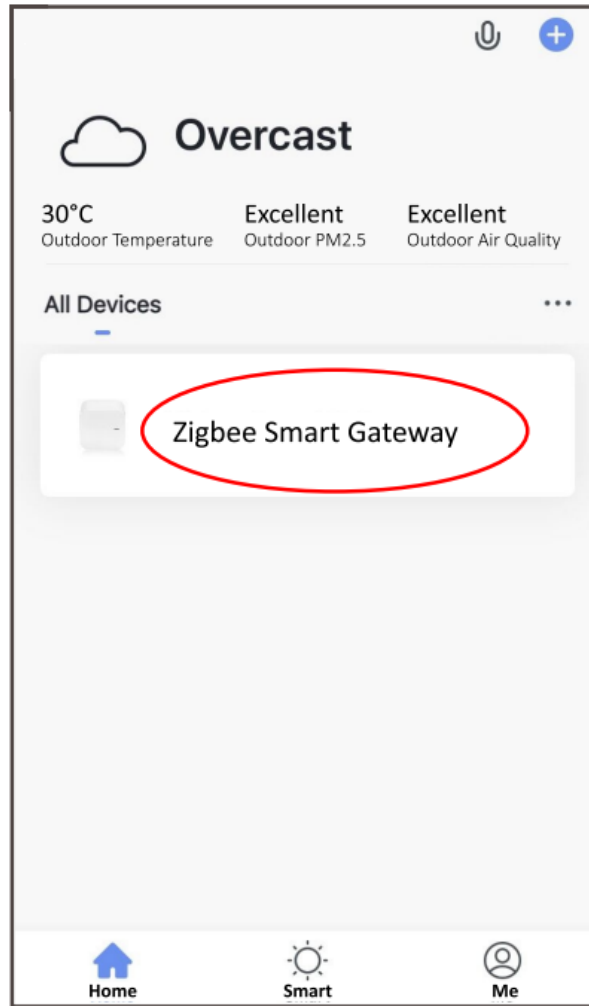

- Press + and Add device

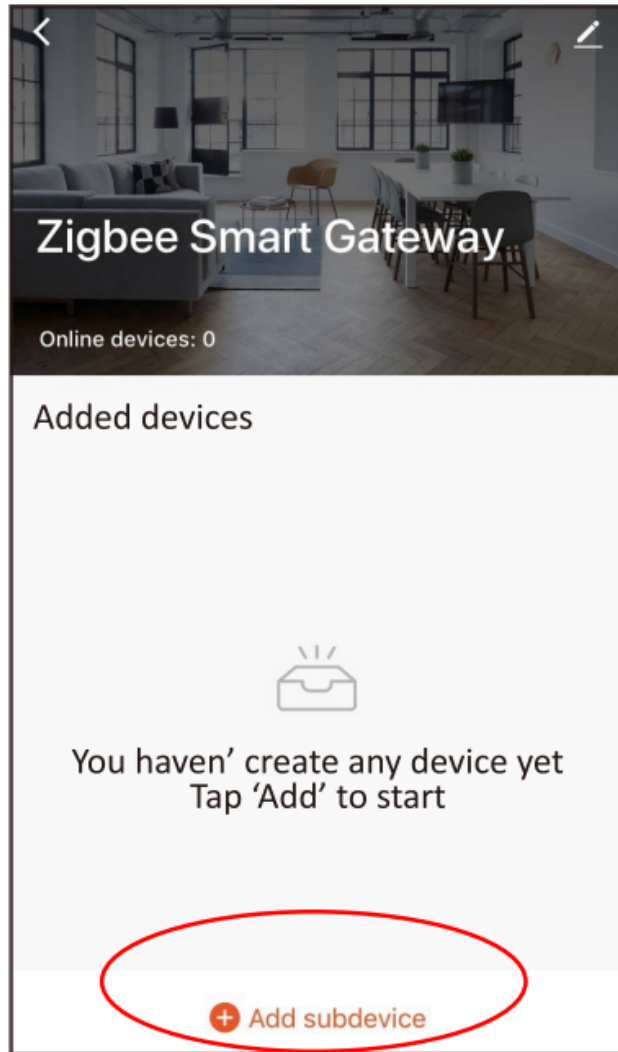

- . Remove the insulation sheet and press the reset button for 5 seconds, till the blue LED blink, then click "LED already blink" on the app.

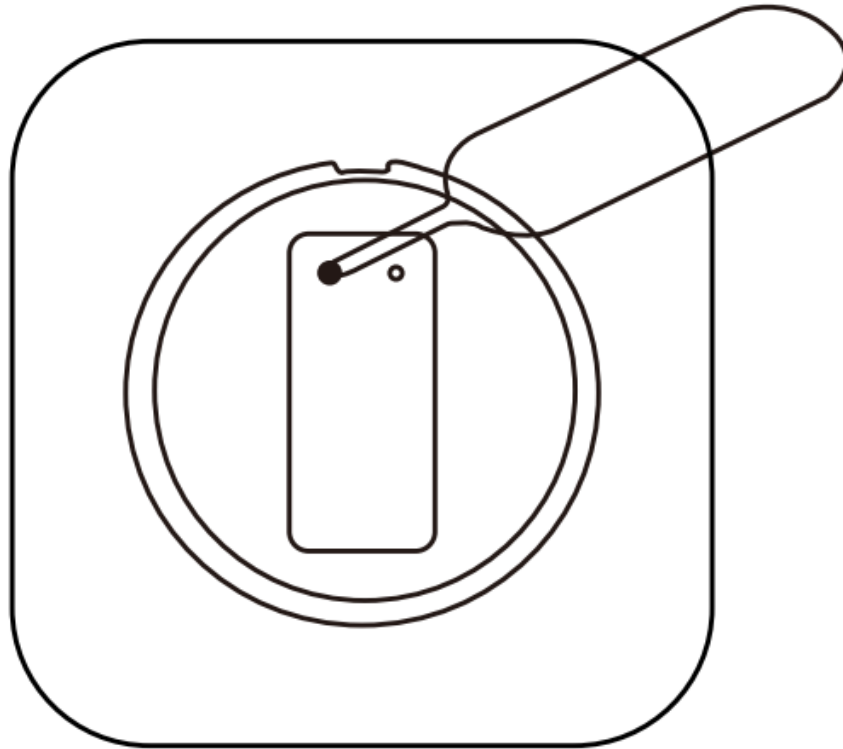

- Waiting for a few seconds, you can see the this device is shown and you may rename it.

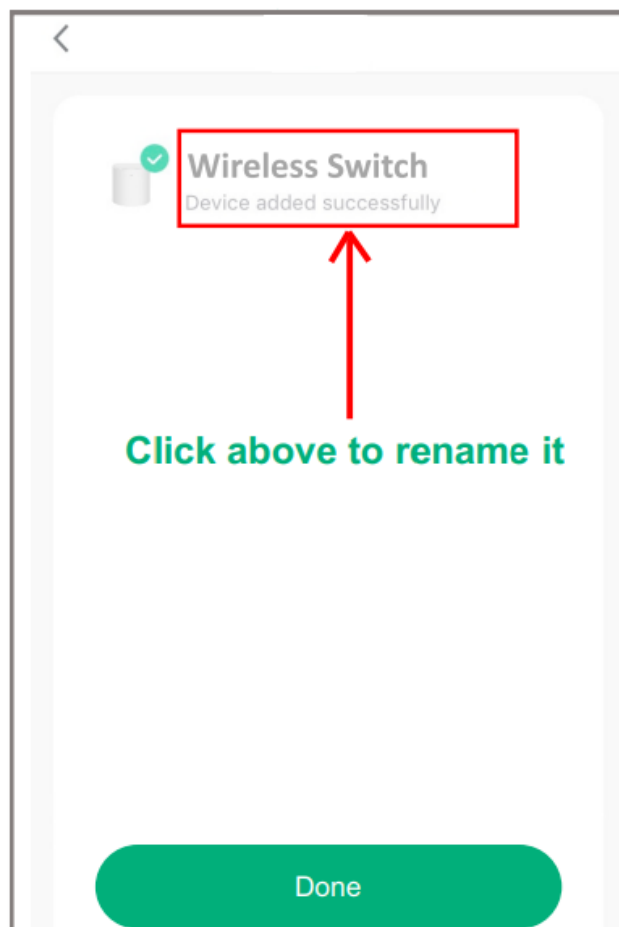

- Set the function of button with single click/double click/long press.

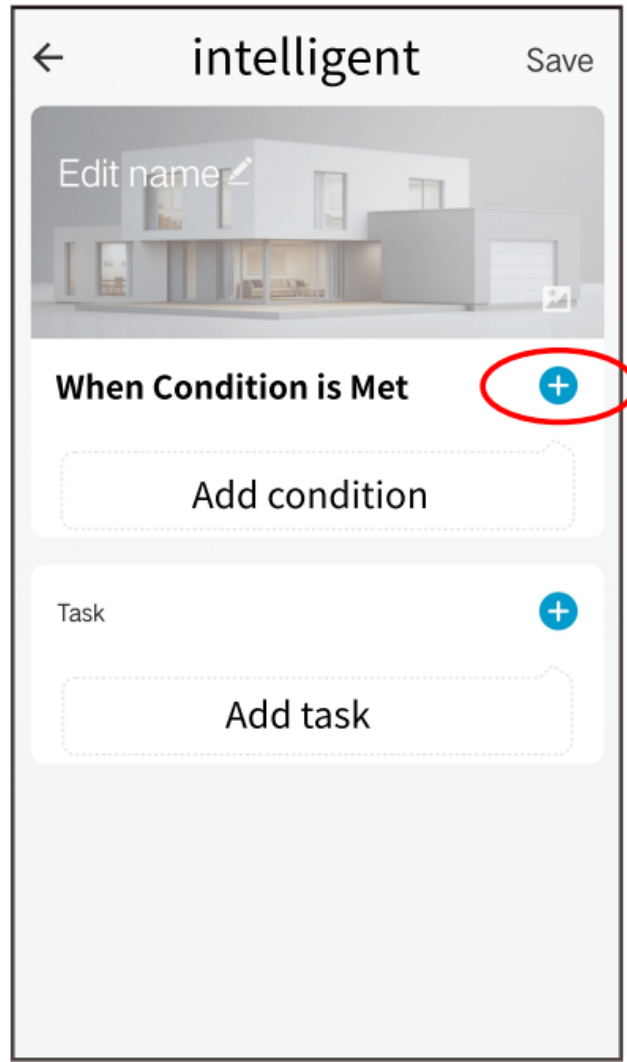
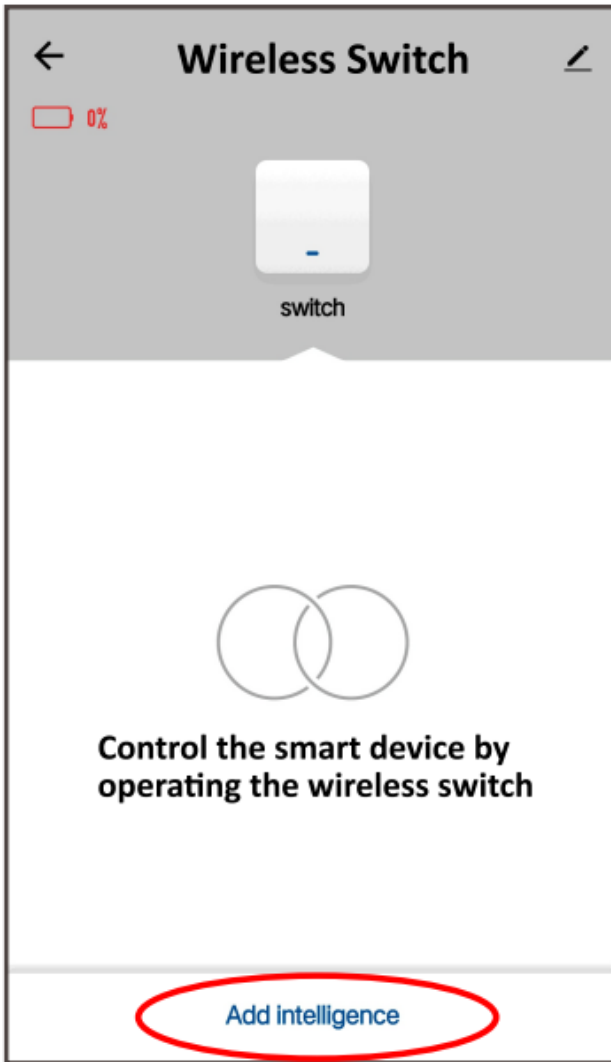

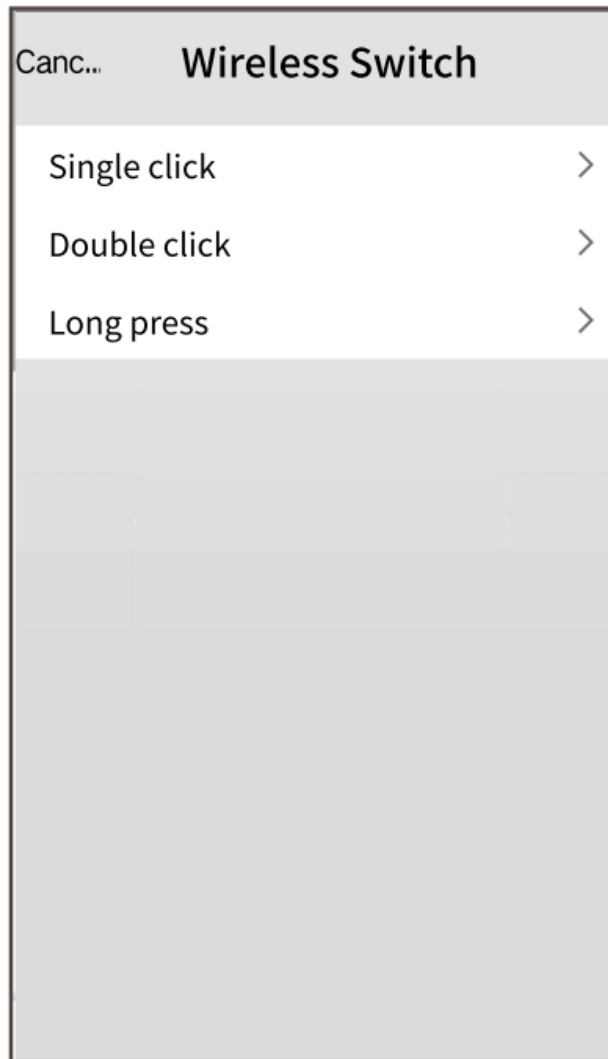

How to connect your device with Alexa

1. You have to have Alexa app on your smartphone
2. Go to settings and press "Skill and Games"
3. Search for the Nour Smart Home skill
4. Enable it
5. Link your Nour account with Alexa
6. Ask Alexa to discover new devices

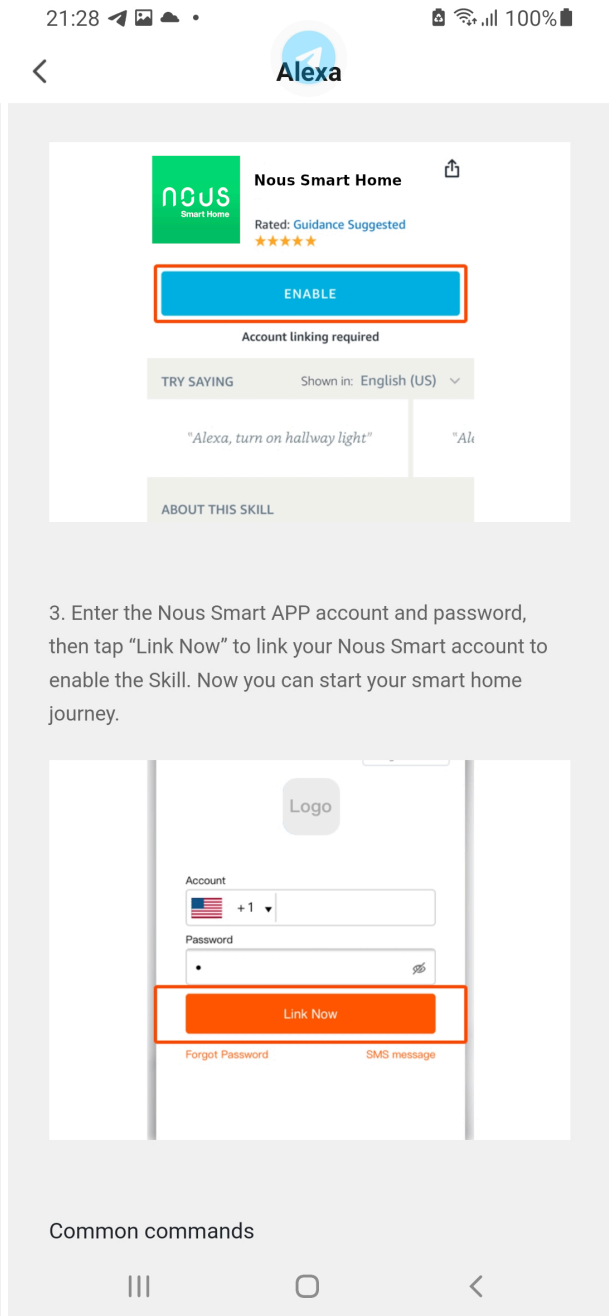
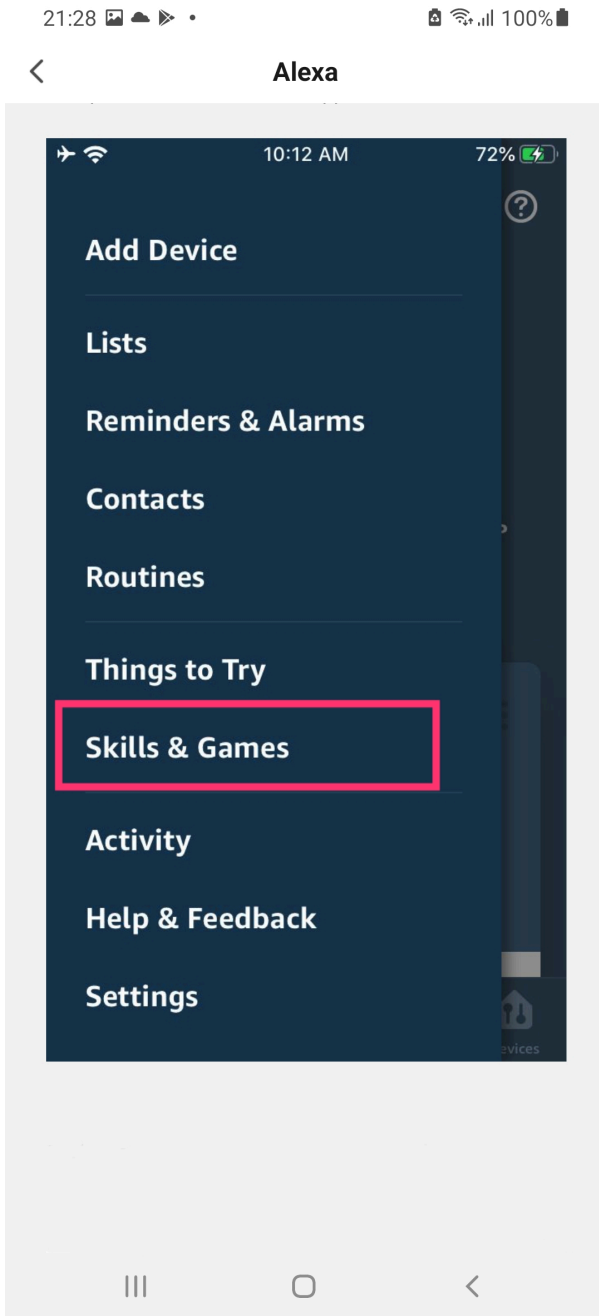

How to connect your device with Google Home

1. You have to have Google Home app on your smartphone
2. Go to the home settings and press "works with google"
3. Search for the Nous Smart Home
4. Link the account with the Google Home
5. All devices from Nous Smart app will appear in Google Home after synchronization

